

Sheffield Univ. Maple 15 Installation Notes

IMPORTANT: Before installation you must obtain the Maple purchase codes for Maple14 via: <http://www.sheffield.ac.uk/wrgrid/software/maple.html> . You will be asked to enter this code during step (11) below.

A. General Installation Notes

Pre-Installation: Minimum Requirements: Hard Disk: 1.3 GB, RAM: 1GB. Note that all Windows/MAC/Linux/Solaris versions are contained in one DVD which makes only the relevant installation files visible during an installation.

- 1) Close all the programs (particularly Excel or previous versions of Maple).
- 2) (Windows) You may have to disable Virus Protection -on-access scan feature just for the duration of Maple installation. *If you get a message of the form unable to run program try another copy of the installation program, suspect interference from Virus Protection software.*

- 3) (Windows) Insert the Maple CD (which should auto-run), but if it fails to do so **Double-Click** the Maple CD Icon on *My Computer*. If that fails too, explore the CD; go into the folder `Windows\Disk1\InstData\VM` and double click `Maple15windowsInstaller.exe` in that folder. If you are using 64bit version of Windows the corresponding install program can be found at

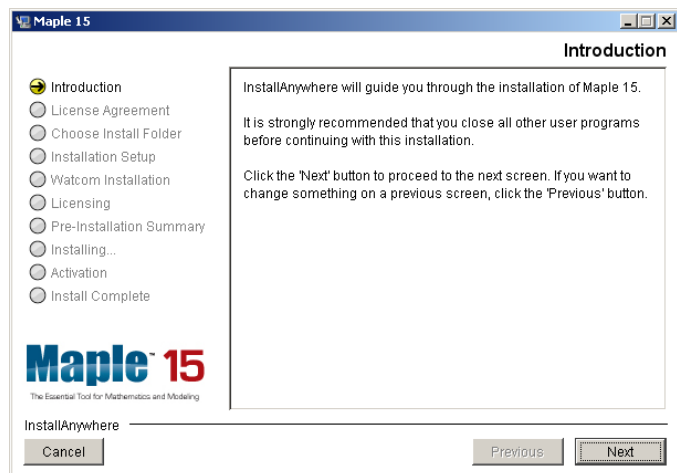

`Windows64\Disk1\InstData\VM\Maple14WindowsX86_64Installer`

(Linux and MAC) please see extra instructions in section (B) below.

- 4) As installation starts, you will be able to select the installation folder. On windows, the default location of `C:\Program Files\Maple 15` can be accepted.
- 5) You will be given the choice of (Full) (Minimal) and (Custom) installations. The major difference between the (Full) and (Minimal) installations is the installation or otherwise of the Watcom C-Compiler. This compiler is used for the Maple compiler feature,

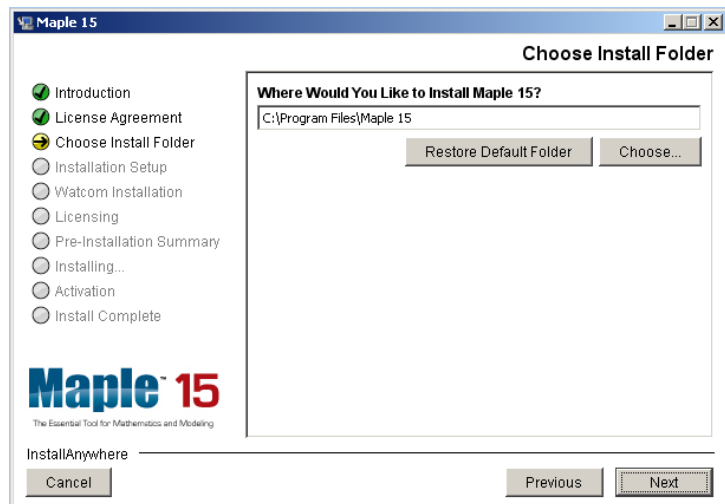

which allows you to compile some types of user-written Maple routines to speed up the performance of Maple.

6) After a few more interactions where default answers can be safely accepted you will be asked to select between single user and network licensing options.

7) If you had previously installed Matlab on your workstation you may also get an option to link Maple with Matlab via the Maple Toolbox for Matlab. (See figure)

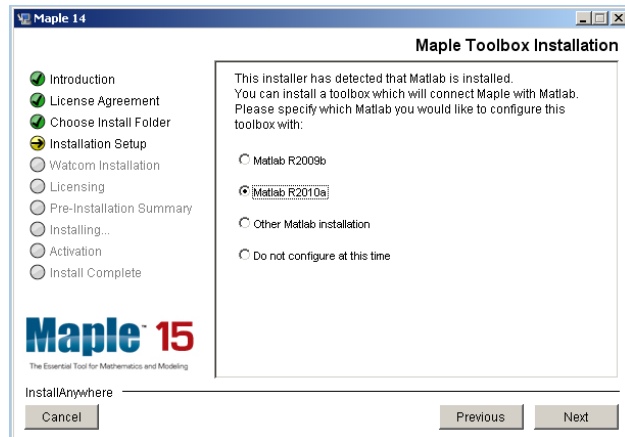

8) At Sheffield University we will be providing floating Maple licenses mainly for the mainframe Linux and managed/XP workstations. However if you are installing Maple onto your own workstation we recommend that you **select the Single User License** option. The advantage of this will be ;

a) You will not be affected if the license server goes down or you get disconnected from the network.

b) You will be able to use Maple on your computer while away from campus.

If you opt for the Network license you should specify **licserv2.shef.ac.uk** as the server and **27003** as the port number.

9) Installation should begin.

10) Towards the end of the installation process, you will be asked to activate the license. This involves the installation program contacting the Maple web site directly via the Internet. Therefore, if you are not already connected to the Internet, you should connect now. To proceed with the activation, select **Activate now** and continue.

11) When presented with the Maple Activation Screen, enter the 'purchase-code' i.e. licence activation code obtained via the website above. You will also be asked to enter your contact details. This tedious part of the procedure will work even if you fill in only the fields that are marked in RED. I.e. your name, email-address and country (United Kingdom).

12) Proxy Server Information: Your computer will most probably be connected to the Internet directly, however, if you have a home-computer network where internet access is indirect via a designated proxy server, you must also enter details of your proxy server on this page.

13) Installation will complete after a few more minutes.

14) You may have to restart your workstation before running Maple. When you first run Maple you may get a 'Windows Firewall' warning asking you if it is OK to allow Maple to by-pass the firewall. You should choose **UNBLOCK** the firewall.

IMPORTANT NOTES on ACTIVATION: Maple licenses normally get renewed during August. If your Maple licence is about to expire you should revisit the annual code renewal page referenced above and obtain the new activation codes and re-activate Maple.

- For Windows ; run **Programs → Maple15 → Tools → Activate Maple15.**

Note that for Windows Vista or 7 you will need to Right Click and **Run as Administrator**.

- For Linux environments run `$MAPLE_DIRECTORY/bin/activation`.
- For Apple/MAC run script **activation** located in the **bin** folder of your Maple 15 installation. By default, `/Library/Frameworks/Maple.framework/Versions/15/bin`.

If you encounter problems:

- a) Has the licence code expired? – see **important notes** above.
- b) Has activation been deferred? If you were unable to connect to the Internet at the time of installation, you will have selected ‘Skip’ on step (8) above. Maple will be installed, but cannot be used until activated. When you are ready to activate Maple, connect to the Internet and activate Maple as described above.
- c) Read file **Install.html** located on the DVD .This is also posted on our Maple URL above.

Network Resources:

Maple Primes: This service aims to provide user interaction blogs/forums, resource sharing etc. amongst Maple software users and is located at <http://beta.mapleprimes.com/> .

Activation will also result in an email to you that will allow you to subscribe to Maple announcements etc. if you wish to do so.

B. Extra instructions for Linux Linux/64 and Apple MAC users

On some Linux environments the DVD, when inserted, will not auto-mount and you will have to do that manually as *superuser*. For example on latest UBUNTU environment you will need to issue the following command;

```
sudo mount -t iso9660 /dev/cdrom /media/cdrom
```

Once the installation is complete you can unmount the DVD.E.g. *sudo umount /media/cdrom*

Please read the **Install.html** file on the relevant CD for the full installation instructions on these platforms. In each case, install the **SINGLE USER** version by using the activation code obtained via the website above. Maple should run on most Linux platforms. If you have problems, please read the file named `readme.txt` on the distribution CD. Also, during the installation make sure to specify a preferably new directory such as `/usr/local/maple` for the installation. Trying to install Maple into a system area such as `/usr/local` or `/usr/bin` may corrupt the computer by overwriting system files. Some versions of Linux will not allow script files (including installation scripts) to be executed directly from the CD. Invoking the script indirectly via bash (e.g. `bash /cdrom/installMapleLinux32`) may be able to get round this problem. Finally make sure that- if your version of Java is 32-bits, you must install the 32-bit version of Maple to avoid problems.

Future Releases of Maple

Future announcements regarding Maple will be made via the URL:

<http://www.shef.ac.uk/wrgrid/software/maple.html>